

PLAN SHOWING PROPOSED A-2/1128/05
 RESIDENTIAL BUILDING ADJACENT TO DOOR No. 42, P.A. I. No. 2808
 ST. MARY'S ROAD, R.A. PURAM, CHENNAI, BEARING S.No.286, R.S.No.4039, BLOCK No.88, IN MYALPORE VILLAGE, CHENNAI DIST. ZONE No.10 DIVISION No.142.

AREA STATEMENT		
	SO.FT.	SQ.M.
TOTAL EXTENT	91 x 51 / 2794.00	259.66
BASMENT FLOOR	876.70	81.47
GROUND FLOOR	1285.00	119.42
FIRST FLOOR	1529.48	142.14
TOTAL AREA	3691.38	343.03
PLOT COVERAGE 54.74%		
F.S.I 1.32		
NON F.S.I AREA 480.30 Sff.		

SCHEDULE OF JOINERY		
MD MAIN DOOR	3'3"x7'0"	(0.99x2.13)
D1 DOOR	3'0"x7'0"	(0.91x2.13)
D2 DOOR	2'6"x7'0"	(0.76x2.13)
W WINDOW	4'0"x4'6"	(1.22x1.37)
W1 WINDOW	2'6"x4'6"	(0.76x1.37)
KW KITCHEN WINDOW	4'6"x3'6"	(1.37x1.09)
V VENTILATOR	2'0"x2'0"	(0.76x0.61)

SCALE : 1"=8'0" (1:100)

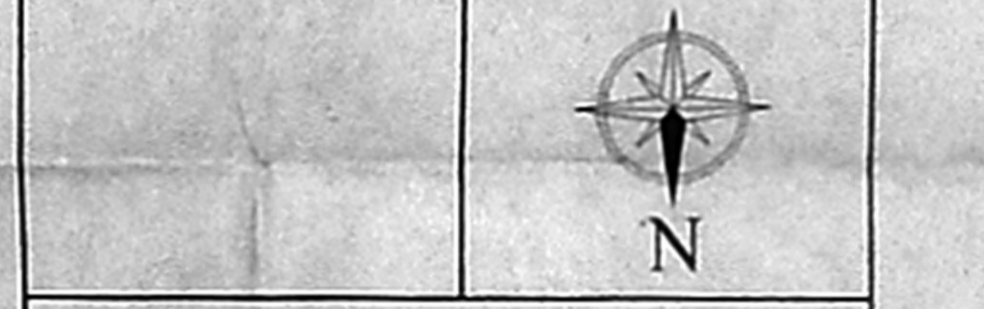

COLOUR CODE	
PROPOSED	
ROAD	
BOUNDARY	

S. Anvalagi
 OWNER SIGNATURE

K. Selvam
ER. K. SELVAM.
 B.E. (Civil), AMIE, C.Eng(I), AIV,
 CHARTERED ENGINEER & APPROVED VALUER,
 CLASS-I LICENSED SURVEYOR,
 Reg. No: 600/2004-2005,
 DOOR No. 11/206, 11th BLOCK,
 MDGAPPAI EAST, CHENNAI-600 037,
 (NEAR MGR ADARSH SCHOOL)
 PHONE No: 26562050
 CELL No: 9841282050
 LICENSED SURVEYOR

